



EFG

EASY FLOOD GATE

USER MANUAL & DEPLOYMENT GUIDE



Installing the Barrier

To help achieve an effective seal, walls need to be **parallel** with one another and at right angles to ground.



Ensure that your entrance is **smooth and clean** of dust and debris at the vertical & base area where EFG is to be installed. Place the EFG towards the flood threat with its edges in contact with the rubber strips.

STEP 1: Use adhesive Rubber strips on three surfaces of entrance & place the EFG on them.

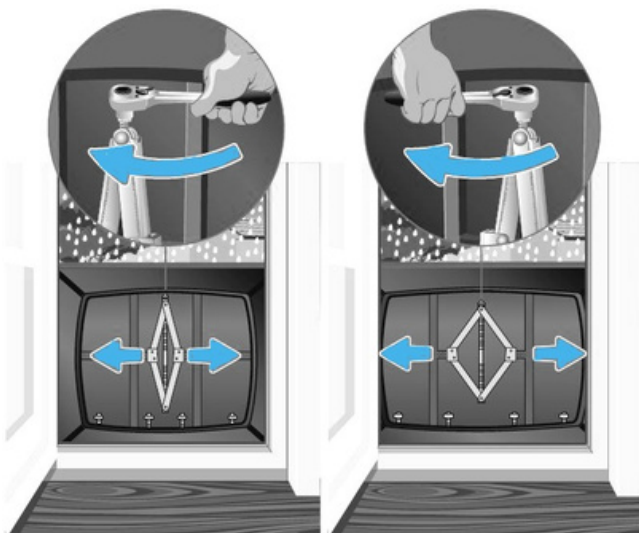

STEP 2: Use the Spanner to expand the jack and lock the barrier **horizontally**.

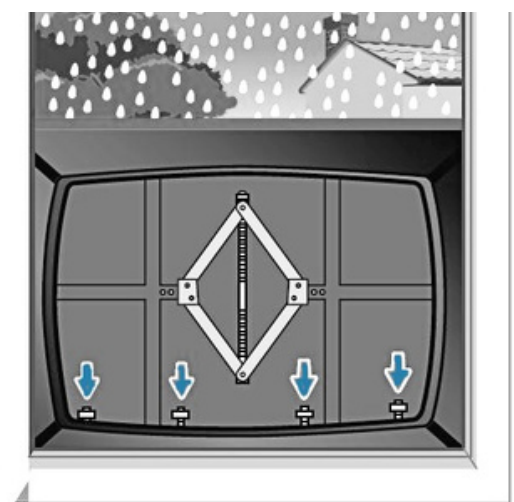

STEP 3: Use the Spanner and equally tighten the six bolts to lock the barrier **vertically**.

 The 6 bolt should be adjusted until it offers resistance and the cover has been compressed sufficiently to create a seal along the floor. Start with the corner most bolts first. **Do not** fully tighten the bolt as it may uplift the gate.

What's Included



1) Flood barrier with neoprene sleeve



2) Spanner



4) User Manual



3) Rubber strip

After-use Maintenance

- ✓ After flood threat has passed, counter turn the 6 downward bolts & jack returning the barrier to its normal state . Remove the barrier from the doorway.
- ✓ Carefully remove the sleeve, clean and dry it in a shaded area.
- ✓ Remove excess moisture from the metal frame using a clean cloth & **apply rust proofing oil or grease to all expandable mechanisms.**
- ✓ After drying the sleeve & steel frame store them in upright position in the original box with inserts.
- ✓ Periodically (atleast every 6 months of non use) examine the kit to ensure proper condition.

Flood Gate Sizes

Determine the appropriate size of Flood Gates to fit your openings.

1. Flood Gate size: **25inch to 30inch**
Height: 26.5 inch
2. Flood Gate size: **30inch to 35inch**
Height: 26.5 inch
3. Flood Gate size: **35inch to 40inch**
Height: 26.5 inch
4. Flood Gate size: **40inch to 45inch**
Height: 26.5 inch
5. Flood Gate size: **45inch to 50inch**
Height: 26.5 inch



Click to
Order on Whatsapp

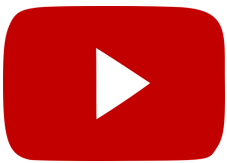

Terms & Conditions

Flood barrier is intended to be used as outlined in this document . Data and information provided in this document is for general information purposes only. Conditions for each use of the Flood Gate will vary and are beyond the control of EFG. EFG cannot guarantee desired results. When purchasing this product from EFG, you agree to assume all risks that may arise from ownership, installation, and use of the Flood Barrier and agree to release EFG from any and all claims brought by any person or entity against EFG related to and/or arising from your ownership, installation, and/or use of the Flood Barrier. EFG shall not be liable for any improper or incorrect ownership, installation or use of this product and assumes no responsibility for anyone's ownership, installation or use of this product. In no event shall EFG be liable for any direct, indirect, incidental, special, exemplary or consequential damages (including, but not limited to: procurement or substitute goods or services; loss of use or profits or business interruption) however caused and on any theory arising in any way out of the use of this product, even if advised of the possibility of such damage. This disclaimer of liability applies to any damages, injury or death, whether based on alleged breach of contract, tortuous behavior, negligence or any other cause of action, including and not limited to damages or injuries caused by any failure of performance, error, omission, defect or delay in operation.

Limited Warranty

EFG warrants this product and components to be free from defects in material and workmanship for a period of one (1) year from date of shipment. If within the term of this warranty, if any Flood Barrier component is found to be defective upon inspection by an authorized EFG representative, EFG will replace or repair, at EFG's discretion, any part found to be defective. The cost of shipping for such return is the responsibility of the user or owner. Unauthorized modification of this product voids this limited warranty. The neoprene sleeve is considered a **“wear-item”** and is not covered under this warranty. Replacements can be purchased from EFG. Moving parts must be properly maintained prior to storage. To make a claim under this warranty, contact EFG at this address: **efgnashik@gmail.com or call us +91 8329062335.**